

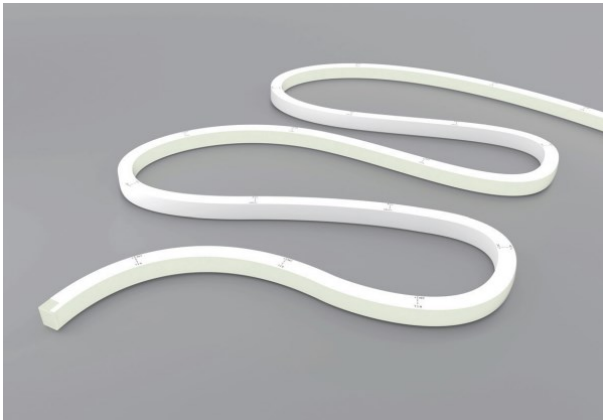

LUMTECH

Néon Souple LED IP67- IP68

Top View



LT-004492

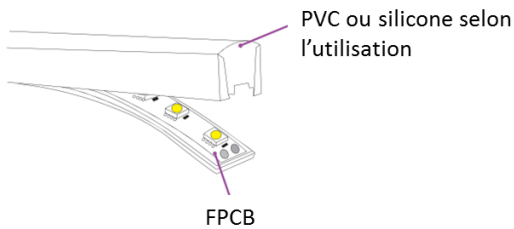
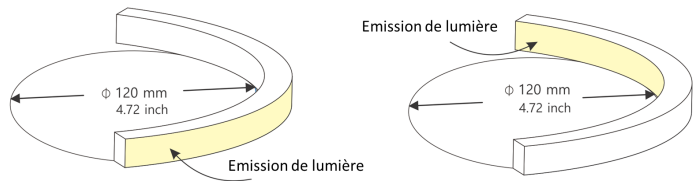

Données photométriques (3000K, CRI80) :

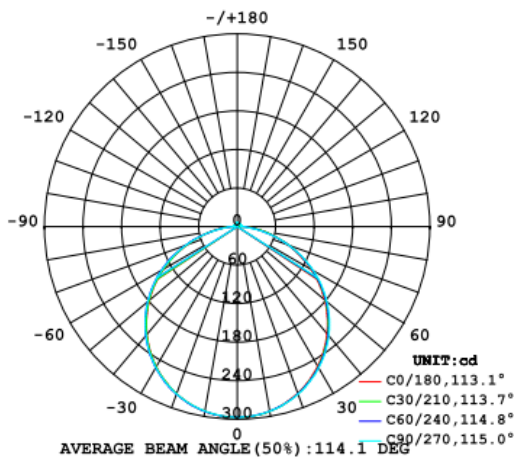

Courbe de distribution de la lumière [Unit : cd]

Flux out: 635.7 lm

Height	Eavg, Emax	Angle: 113.11deg	Diameter
3.281ft 1m	7.927, 27.63fc 85.33, 297.4lx		9.934ft 302.79cm
6.562ft 2m	1.982, 6.906fc 21.33, 74.34lx		19.87ft 605.59cm
9.843ft 3m	0.8808, 3.070fc 9.481, 33.04lx		29.8ft 908.38cm
13.12ft 4m	0.4955, 1.727fc 5.333, 18.59lx		39.74ft 1211.17cm
16.4ft 5m	0.3171, 1.105fc 3.413, 11.89lx		49.67ft 1513.97cm

Note: The Curves indicate the illuminated area and the average illumination when the luminaire is at different distance.

Courbe de Lux distance



LUMTECH

Néon Souple LED IP67- IP68

Top View



Dimensions :

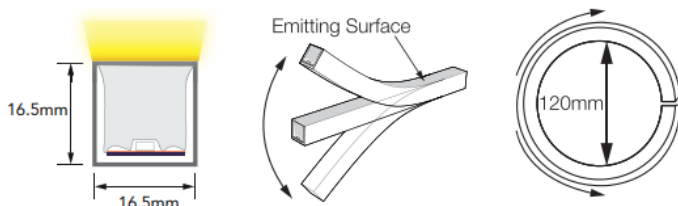

LT-004492

Caractéristiques :

Code	LT-004492					
Matériau	PVC					
Dimensions	16.5 x 16.5 mm					
Puissance	15 W/m					
Température de couleur	2200 K	2700 K	3000 K	4000 K	5000 K	6500 K
Alimentation	DC24V					
Type de LED	SMD 5050					
Quantité de LED	84 LEDs/m					
Flux lumineux (lm/m)	980	1010	1060	1100	1140	1150
IRC	>80 (>90 en option)					
Haute résistance	Eau salée / solvants / poussière / UV / Feu					
Angle du faisceau	120°					
Pas de coupe min	83.3 mm / 7 LEDs					
Direction/Ø de flexion	Verticale / 12cm					
Variation d'intensité	Oui avec driver dimmable uniquement					
Protocole de variation	Fonctionne avec tous types de protocoles de variation selon les caractéristiques du driver dimmable utilisé : DALI, 0/1-10V, DMX, Triac, Bouton Poussoir					
Indices de Protection	IP67 - IP68 (valable uniquement avec les connecteurs moulés en usine), IK08					
Durée de vie	70.000 heures (L70 @25°C) / 50000 heures (L70 @50°C)					
Longueur max. du rouleau	Simple alimentation : 8m / Double alimentation : 16m					
Classe électrique	III					
Certificats	CE - Cmic					
Garantie	2 ans					

Connecteurs IP68 :

LT-003542-16-CO-A



LT-003542-16-CO-B

LT-003542-16-CO-C

Connecteurs IP67:

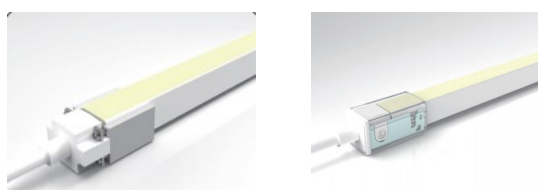

LT-003542-CO-DIY-1

LT-003542-CO-DIY-2



LUMTECH

Néon Souple LED IP67-IP68
Side View



Stop eau :

Interrupteur étanche standard pour néon souple LED version PVC:

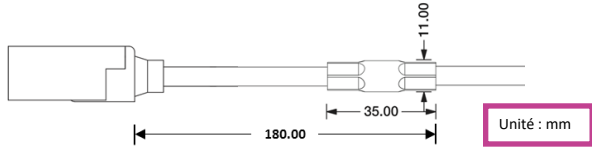

Interrupteur étanche standard pour néon souple LED version silicone:

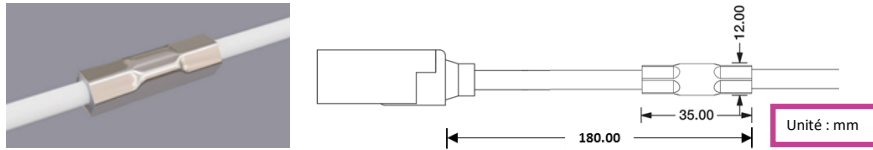

Interrupteur étanche spécial pour installation immergée ou à proximité de l'eau :

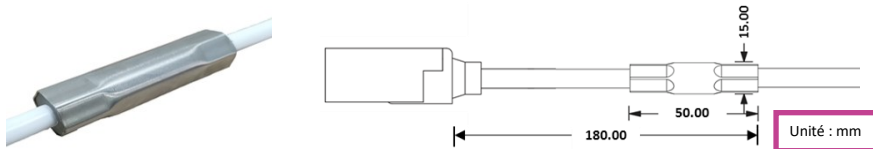

ATTENTION : Un stop eau est présent sur tous les câbles d'alimentations. Il permet d'éviter que de l'eau remonte par capillarité dans le câble et endommage le néon souple LED.

Toutes modifications du câble entre le néon souple LED et le stop eau ou sur le stop eau lui-même annule la garantie.

Profilés et clips

Profilés flexibles :

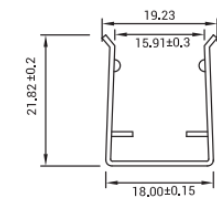
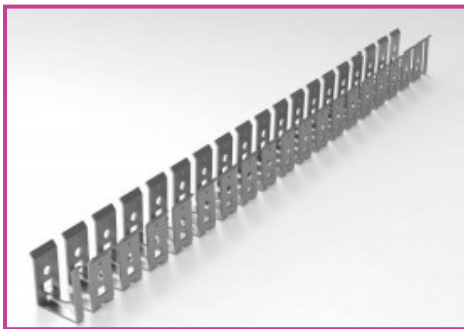

Inox

Installation

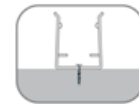

Surface

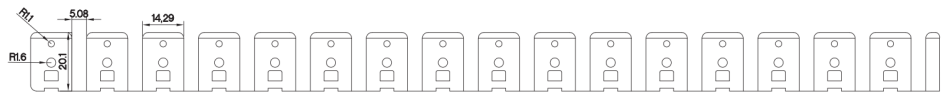

LT10-003542-PROF-INOX-FLEX-100

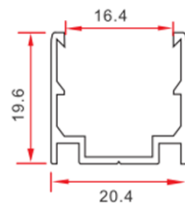
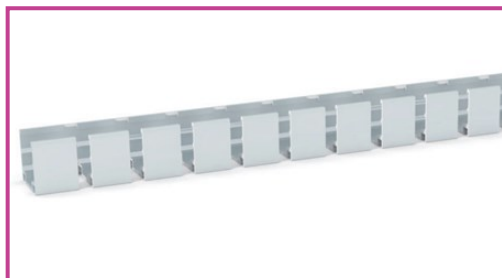

Aluminium

Installation

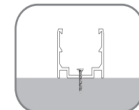

Surface



LT10-003542-17-PROF-ALU-FLEX-100





LUMTECH

Néon Souple LED IP67-IP68

Side View

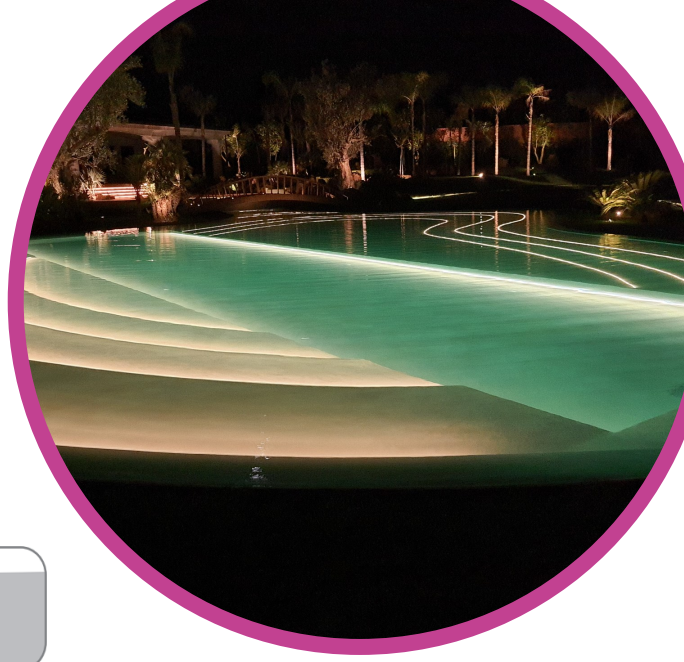

Profilés rigides :

Aluminium



Installation

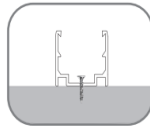

Surface

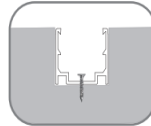

Encastré

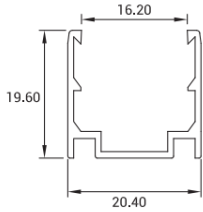

LT10-003542-16-PROF0.35

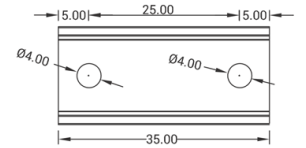

LT10-003542-16-PROF1

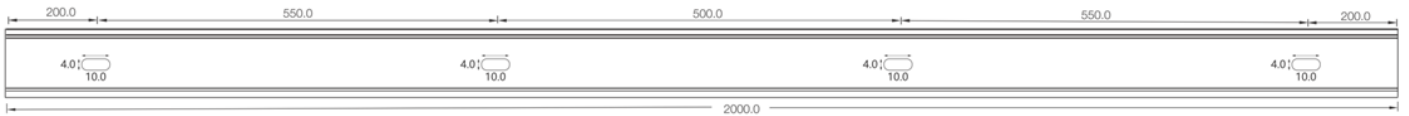
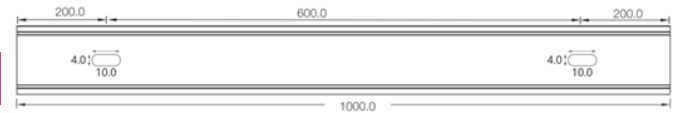

LT10-003542-16-PROF2

PVC

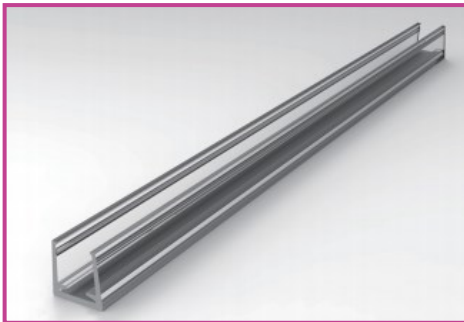

Installation

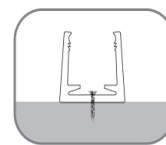

Surface

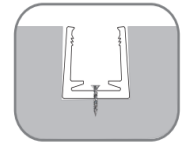

Encastré

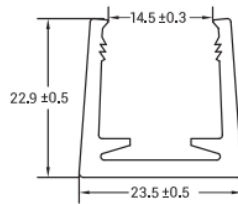

LT-003542-PROF0.35-PVC

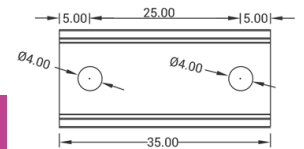

LT-003542-PROF1-PVC

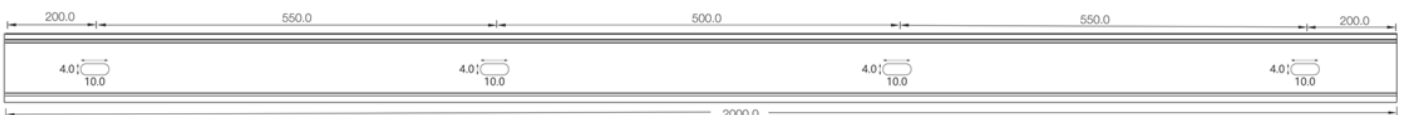
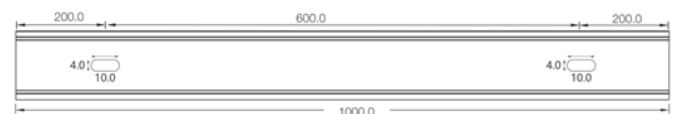

LT-003542-PROF2-PVC



LUMTECH

Néon Souple LED IP67-IP68

Side View



Profils rigides (suite) :

Inox

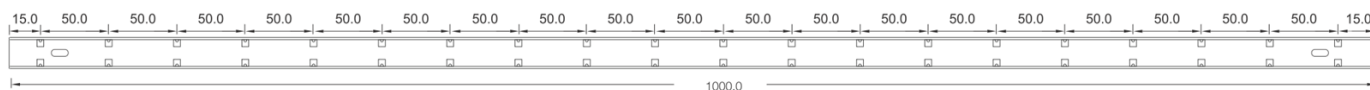
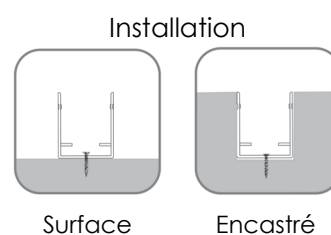
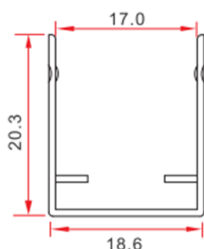
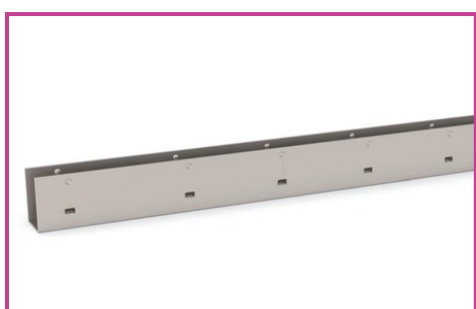

LT10-003542-PROF-INOX

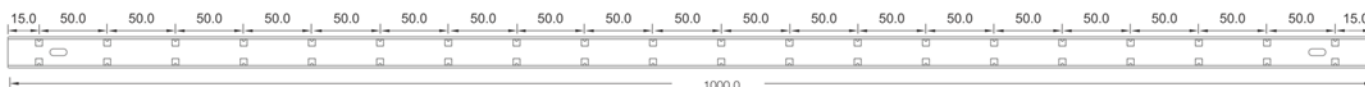
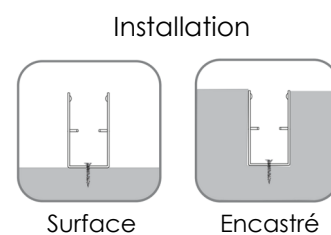
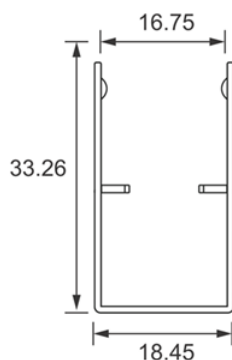

LT-003542-PROF-INOX-BIG



LUMTECH

Néon Souple LED IP67-IP68

Side View



Profilsés rigides (suite) :

Aluminium avec gomme antidérapante

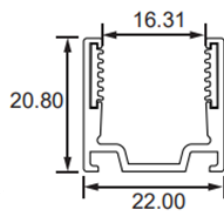

Installation

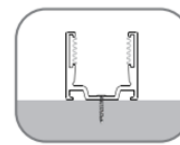

Surface

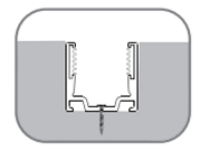

Encastré

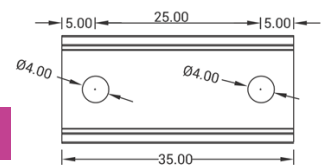

LT10-003542-16-ANTI-DROP-PROF0.35-C

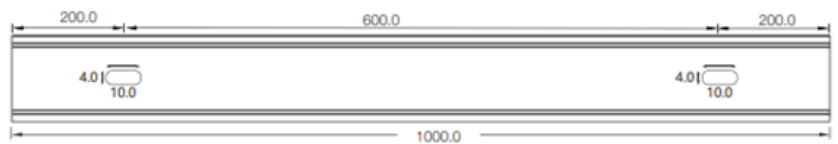

LT10-003542-16-ANTI-DROP-PROF1-C

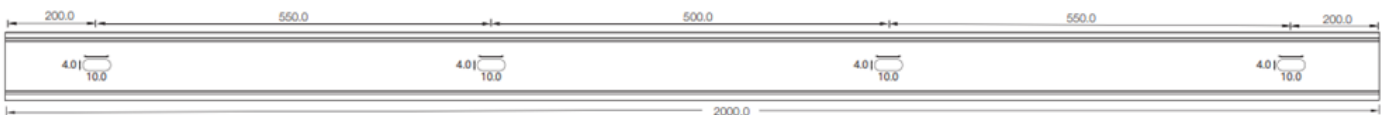

LT10-003542-16-ANTI-DROP-PROF2-C

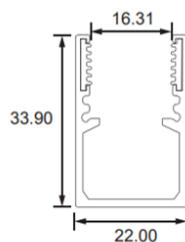

Installation

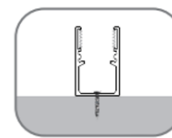

Surface

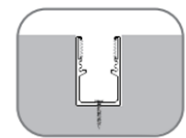

Encastré

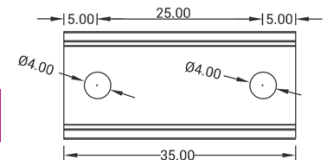

LT10-003542-16-ANTI-DROP-PROF0.35-BIG

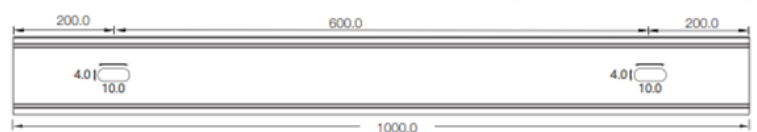

LT10-003542-16-ANTI-DROP-PROF1-BIG

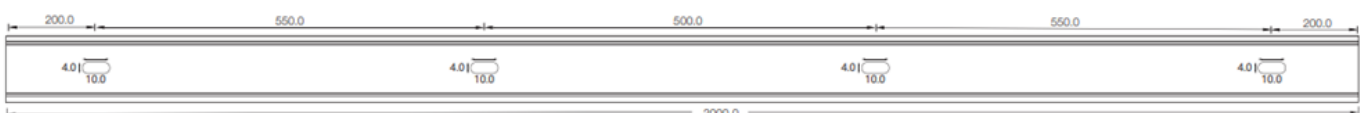

LT10-003542-16-ANTI-DROP-PROF2-BIG



LUMTECH

Néon Souple LED IP67-IP68

Side View



Profils rigides (suite) :

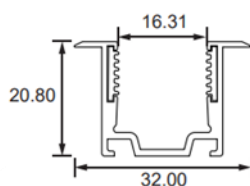

Installation

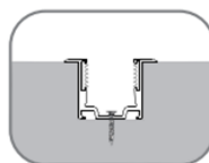

Encastré

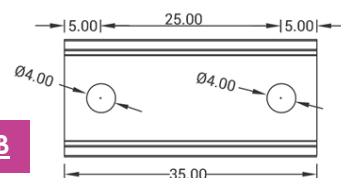

LT10-003542-16-ANTI-DROP-PROF0.35-B

LT10-003542-16-ANTI-DROP-PROF1-B

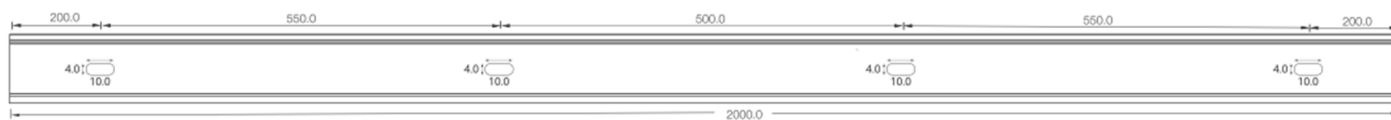
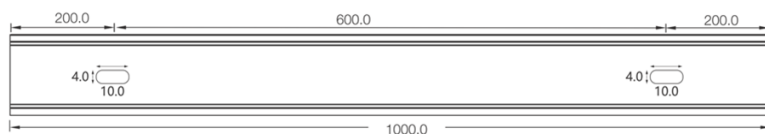

LT10-003542-16-ANTI-DROP-PROF2-B

Clips :

Inox

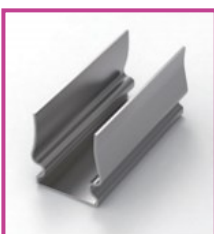

Installation

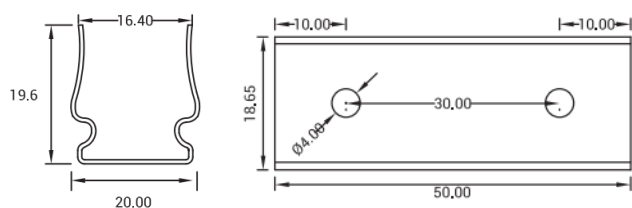

LT-003542-CLIP-INOX

PVC



Installation

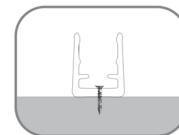

Surface

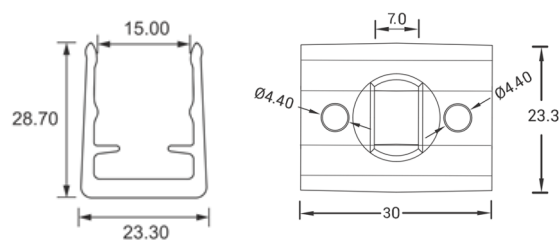

LT-003542-CLIP-PVC